



- 2 cylinders
- 954 cm³
- 17 kW/23.1 HP
- 3600 r.p.m.
- Nm. 55@2100

Homologation

- EPA TIER 2 *
- ECE R 24-03 ▲

Construction

- 4-stroke air cooled diesel engine
- Direct injection
- Air cooled by fan integral to the flywheel
- Mechanical fuel lift pump
- Forced lubrication with oil pump
- Full flow oil filtration with external cartridge filter
- Automatic mechanical fuel supplement
- Torque regulator
- Centrifugal speed governor
- Crankcase in die-cast aluminium
- Electric starting
- Counter-clockwise rotation (viewed from power take-off side)
- Aluminium alloy independent heads
- Independent cast-iron cylinders
- Power take-off on crankshaft



Applications

- Dumper
- Vibrating Roller
- Generating Set
- Welding Set
- High pressure cleaner
- Hydraulic power pack
- Agricultural pump
- Two-wheel tractor

* EPA - For information contact Lombardini.

Specifications

Cylinders	N.	2
Displacement	cm ³	954
Bore	mm	90
Stroke	mm	75
Compression ratio		19:1
Rating kW/HP	N (80/1269/CEE) ISO 1585	17/23.1
	NB ISO 3046 IFN	15.7/21.4
	NA ISO 3046 ICXN	14.5/19.7
Max. torque	Nm.	55@2100
Max. torque 3 P.T.O.	Nm.	25.0
Counterclockwise rotation		
Engine speed - 3 P.T.O. ratio		1:0.89
Minimum idling speed r.p.m.		1000
Fuel tank capacity	l	7
Oil consumption	kg/h.	0.011
Oil sump capacity	l	3
Min. allowable oil pressure	bar	0.8
Max. allowable inclination for short periods of operation (peak values)		25° (35°)
Vol. of air required for correct combustion @ 3600/3000 r.p.m.	l/min.	1500/1220
Vol. of air required for correct cooling @ 3600/3000 r.p.m.	l/min.	15800/13200
Dry weight	kg	78
Recommended battery	V/Ah	12/55
Axial load	(continuous)	kg 100
	(intermittent)	kg 350

Minimum pulley diameters for belt drive

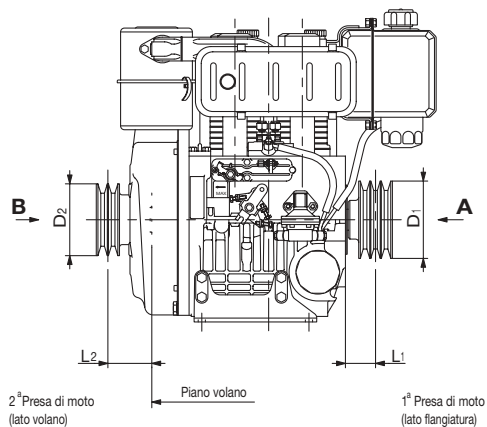

$$D_1 \text{ (mm)} \geq 220 [78+L_1 \text{ (mm)}] \quad \begin{matrix} N \text{ (kW)} \\ n \text{ (RPM)} \end{matrix}$$

$$D_2 \text{ (mm)} \geq 196 [150+L_2 \text{ (mm)}] \quad \begin{matrix} N \text{ (kW)} \\ n \text{ (RPM)} \end{matrix}$$



Sound pressure level dB (A)

Sound level polar diagram open field - 7 meters microphone - no load running engine.

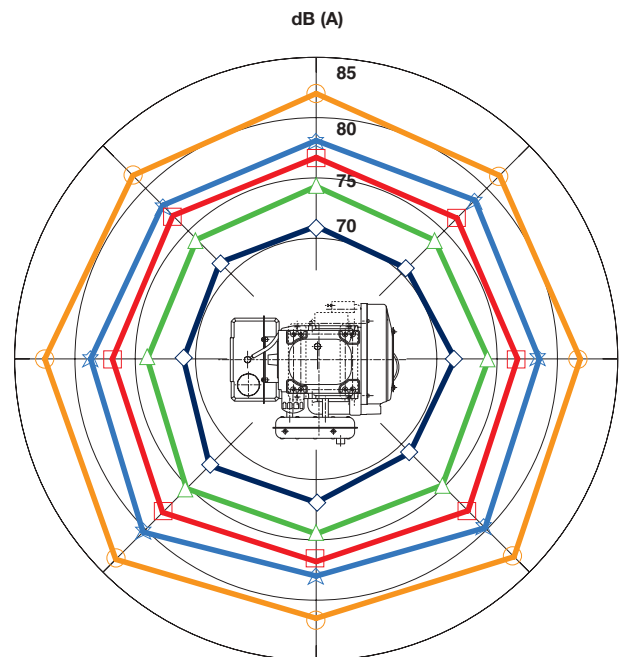

1500 RPM 2000 RPM 2500 RPM 3000 RPM 3600 RPM

SERIE RD

Curves

RD 210 B1 @ 3000 r.p.m. ▲

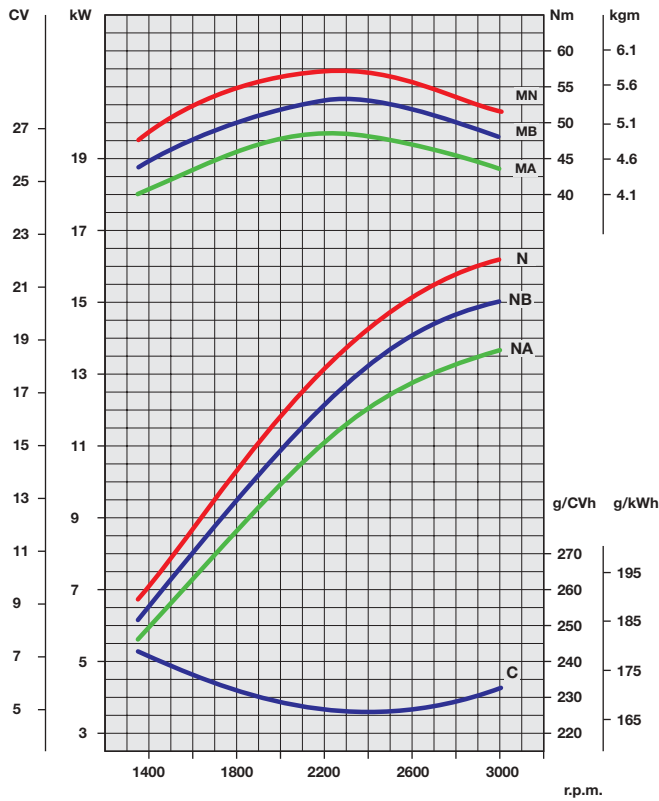

RD 210 B2 @ 2800 r.p.m. ▲

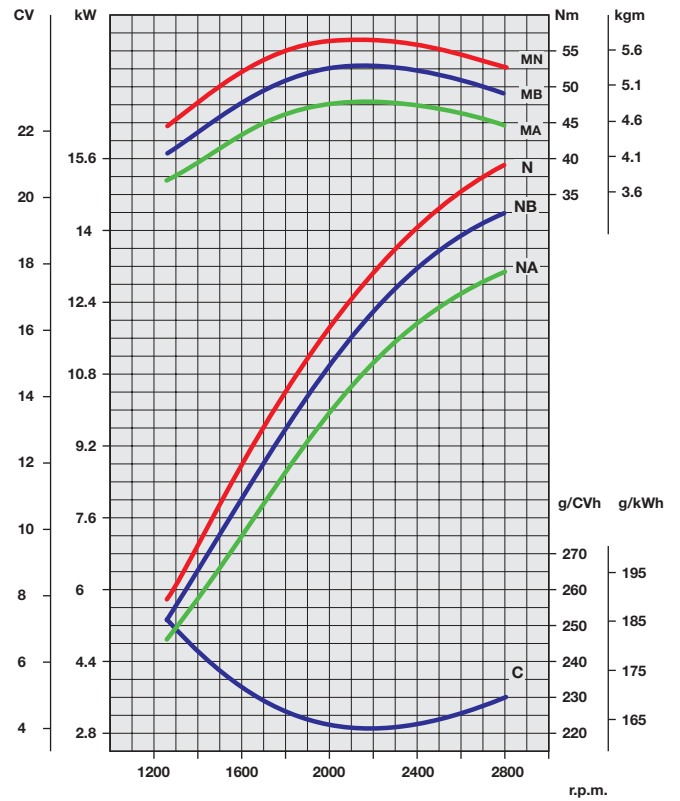

RD 211 @ 3600 r.p.m.

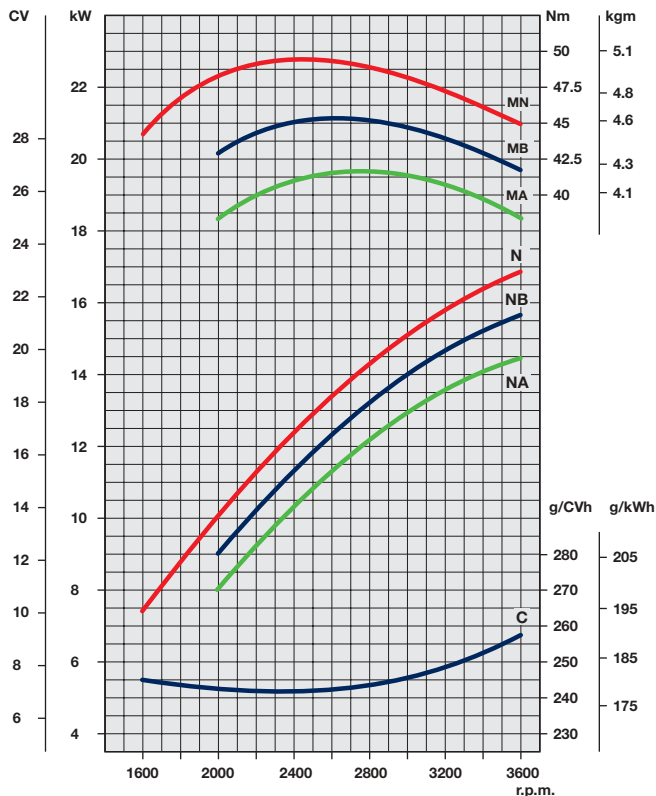

N Power curve - 80/1269/CEE - ISO 1585 -

NB Power curve - ISO 3046/1 - IFN -

NA Power curve - ISO 3046/1 - ICXN -

MN Torque curve - (N curve)

MB (B curve - **MA** (A curve)

C Specific fuel consumption - (NB curve)

Output power for fixed speed application (including generating sets)

Engine power kW

r.p.m.	Intermittent (NB)	Continuous (NA)
3600	15.7	14.5
3000 (RD210)	14	12.9
1800	9.0	8.1
1500	7.7	7.0

Technical drawings *

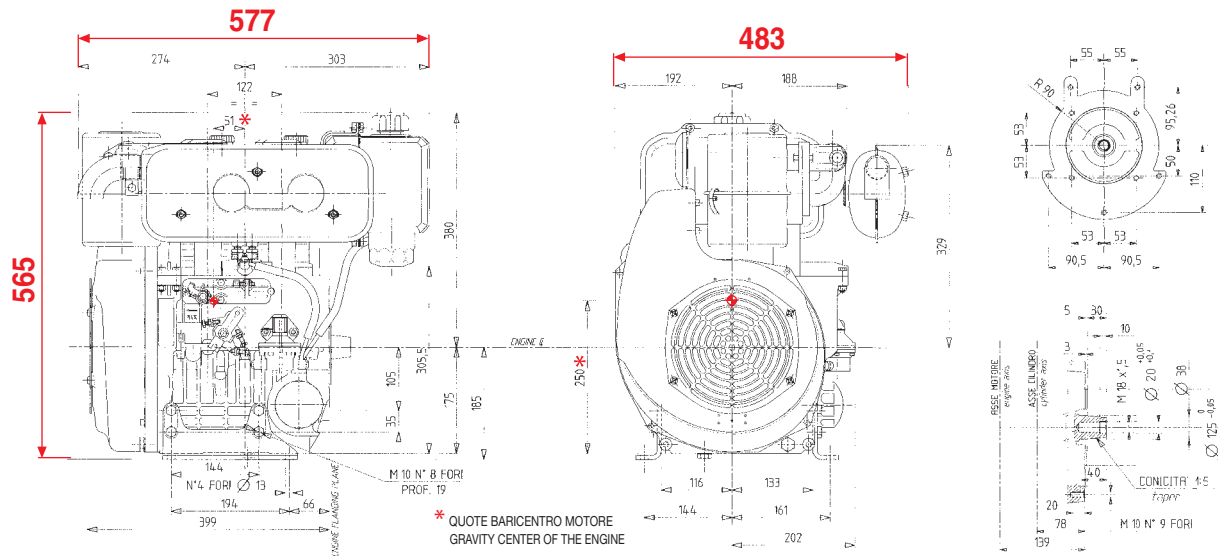

* More specific dimensions are available on www.ruggerini.it (see table at the bottom of the page)

Standard equipment

- Electric starter with 12V alternator
- Black paint on sheet metal parts
- Remote throttle
- Oil bath air filter
- External oil filter
- Oil pressure switch
- Combined manifold and exhaust muffler
- Ø 38 mm conical shaft power take-off
- Fuel lift pump
- Counter-clockwise rotation on power take-off side
- Fuel tank with filter
- Automatic mechanical supplement
- User maintenance - spare parts booklet

Accessories on request

- Different guards according to use
- Range of alternative alternators
- Engine feet
- Compression release
- Flanges
- Control board
- Detached dry air filter
- External fuel filter
- Clutches
- Range of flywheels for various clutches
- Hydraulic pump adapters
- Range of fuel tanks of various sizes
- Mufflers and exhaust pipes
- Controls
- Pulleys
- Varnishing



Via Cav. del Lavoro Adelmo Lombardini, 2
42100 Reggio Emilia - Italia
Tel. ++39 0522.3891 - Fax ++39 0522.389503
www.ruggerini.it

Files for this product available on www.ruggerini.it

Data sheet	RD211DS.PDF
Owner manual	RD211OM.PDF
Service manual	RD211SM.PDF
Technical drawing	RD211TD.DWG
Power curve	RD211PC.PDF

RUGGERINI RESERVES THE RIGHT TO MAKE MODIFICATIONS WITHOUT PRIOR NOTICE

cod. 3558189 - 11/2005 - mod. 51020/5

trademark of

 LOMBARDINI